

## Końcówki rurkowe do przewodów cienko żyłowych

- Z rurki
- Materiał: Miedź elektrolityczna 99,9 % E-CU DIN 40500
- Powierzchnia: cynowane

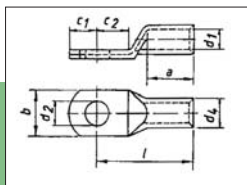

Cu

Art. nr.	p.prz.	M	d1	d2	d4	a	b	c1	c2	i	sztuk	kasetka
29 02 50	10	6	5	6,4	8	16	11,5	6,00	7,0	23	100	1000
29 02 52		8		8,4		17	13,5	7,00	9,0	26	100	800
29 02 54		10		10,5		16	16,0	8,00	10,0	26	100	600
29 02 56		12		13,0		17	19,0	10,00	14,0	31	100	600
29 02 58	16	6	6	6,4	9	17	13,0	7,00	9,0	26	100	600
29 02 60		8		8,4		17	13,0	7,00	9,0	26	100	400
29 02 62		10		10,5		16	16,0	10,00	12,0	28	100	400
29 02 64		12		13,0		22	22,0	12,00	13,0	35	100	400
29 02 66	25	6	8	6,4	11	20	16,0	7,00	10,0	30	50	400
29 02 68		8		8,4		20	16,0	8,00	10,0	30	50	400
29 02 70		10		10,5		20	17,0	10,00	12,0	32	50	300
29 02 72		12		13,0		22	22,0	12,00	13,0	35	50	300
29 02 76	35	8	9	8,4	13	25	18,0	10,00	10,0	35	40	240
29 02 78		10		10,5		24	18,0	10,00	11,0	35	40	160
29 02 80		12		13,0		26	22,0	12,00	14,0	40	40	160
29 02 82	50	8	11	8,4	14,5	27	21,0	11,00	12,0	39	25	150
29 02 84		10		10,5		27	21,0	11,00	12,0	39	25	150
29 02 86		12		13,0		27	21,0	12,00	14,0	41	25	100
29 02 88		16		17,0		27	27,0	15,00	17,0	44	25	100
29 02 90	70	8	13	8,4	17	32	25,0	11,00	12,0	44	25	100
29 02 92		10		10,5		32	25,0	11,00	12,0	44	25	100
29 02 94		12		13,0		32	25,0	12,00	14,0	46	25	100
29 02 96		16		17,0		32	28,0	15,00	17,0	49	25	100
29 03 00	95	10	15	10,5	20	37	229,0	15,00	17,0	54	25	100
29 03 02		12		13,0		37	29,0	15,00	17,0	54	25	100
29 03 04		16		17,0		37	29,0	15,00	17,0	54	10	40
29 03 06	120	10	17	10,5	22	41	32,0	15,00	17,0	58	20	80
29 03 08		12		13,0		41	32,0	15,00	17,0	58	20	80
29 03 10		16		17,0		41	32,0	15,00	17,0	58	18	72
29 03 12		20		21,0		41	32,0	15,00	17,0	58	15	60
29 03 16	150	12	19	13,0	25	48	36,0	15,00	17,0	65	12	72
29 03 18		16		17,0		48	36,0	15,00	17,0	65	12	48
29 03 20		20		21,0		48	36,0	19,00	20,0	68	12	48
29 03 22	185	12	21	13,0	27	54	39,0	15,00	17,0	71	20	40
29 03 24		16		17,0		54	39,0	15,00	17,0	71	20	40
29 03 26		20		21,0		54	39,0	19,00	20,0	74	20	40
29 03 28	240	12	24	13,0	30	56	44,0	19,00	20,0	76	15	30
29 03 30		16		17,0		56	44,0	19,00	20,0	76	15	30
29 03 32		20		21,0		56	44,0	19,00	20,0	76	15	30
29 03 34	300	12	26	13,0	32	62	48,0	21,00	31,0	93	8	16
29 03 36		16		17,0		62	48,0	21,00	31,0	93	8	16
29 03 38		20		21,0		62	48,0	21,00	31,0	93	8	16

## Złączki dla przewodów cienko żyłowych

- Z rurki
- Materiał: Miedź elektrolityczna 99,9 % E-CU DIN 40500
- Powierzchnia: cynowane

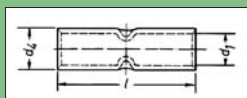

Cu

Art. nr.	p.prz.	d1	d2	l	ciężar/100 sztuk	sztuk	kasetka
29 03 50	10	5	8	30	0,75	50	600
29 03 52	16	6	9	35	0,89	50	500
29 03 54	25	8	11	35	1,4	50	200
29 03 56	35	9	13	35	2,2	25	200
29 03 58	50	11	14,5	45	2,6	25	100
29 03 60	70	13	17	45	3,4	25	50
29 03 62	95	15	20	45	5,7	25	50
29 03 64	120	17	22	55	6,2	25	50
29 03 66	150	19	25	65	10	25	50
29 03 68	185	21	27	70	14	18	36
29 03 70	240	24	30	70	16	6	12
29 03 72	300	26	32	75	17		6
29 03 74	400	30	36	75	18		6

